



1313 AC



1313 AC

PRODUCT INFORMATION:

The TYRI 1313 AC is a low energy (61W), bright and durable work light. It is suitable for larger conveyors or AC powered machinery giving an output of 3700 effective lumens.



IP 69K



VIBRATION TESTED



SALT SPRAY TESTED

Operating Temp: -40° to 50°C

Light Pattern: Symmetric
Asymmetric, High

Lens Material: Plastic, Glass

Housing: Cast Aluminium

Dampened

Mounting Options:
Hanging, Standing, Side,

Connector: (DT04-2P) Built in

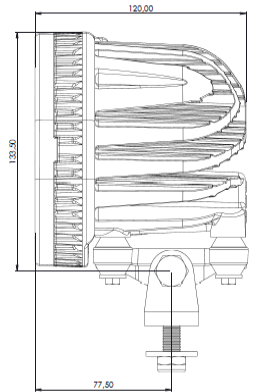
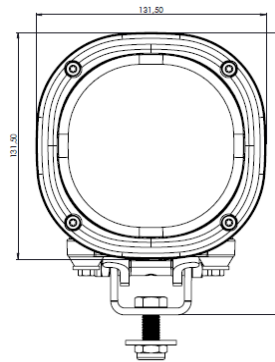

LUMEN OUTPUT		Number of LED'S	VOLTAGE		AMP DRAW		Power (Watts)	Colour Temp	CRI	IP 69K	Vibration 5-2000hZ 3 Axis	Salt Spray ASTMB117
Theoretical	Effective		Machine	Operating Range	120V/60hz	240V/60Hz						
5900	3700	24	110-277 Nominal/ 47-63Hz	85 264	0.52	0.26	61	5300-6000	70	●	8 Grms	●